

WELCOME!

WHY WE ARE HERE ...

THE PURPOSE OF THIS EXHIBITION IS TO PROVIDE INFORMATION ON OUR PROPOSAL TO REPLACE THE CROWN HOUSE WITH A BRAND NEW LEISURE AND RETAIL COMPLEX.

- > A NEW 7 SCREEN ODEON CINEMA
- > 3 NEW HIGH STREET CHAIN RESTAURANTS
- > 4 NEW LARGE RETAIL SHOPS
- > IMPROVED LANDSCAPED PUBLIC SQUARE
- > CREATION OF AROUND 130 JOBS

WE ARE ALSO HERE TO RESPOND TO YOUR QUESTIONS AND LISTEN TO YOUR COMMENTS, WHICH WILL INFORM THE FINAL PROPOSAL THAT WILL BE SUBMITTED TO BROMLEY COUNCIL AS A PLANNING APPLICATION IN JUNE 2012.

PLEASE LET US KNOW WHAT YOU THINK OF THE PROPOSAL BY COMPLETING A COMMENT FORM BEFORE YOU GO.

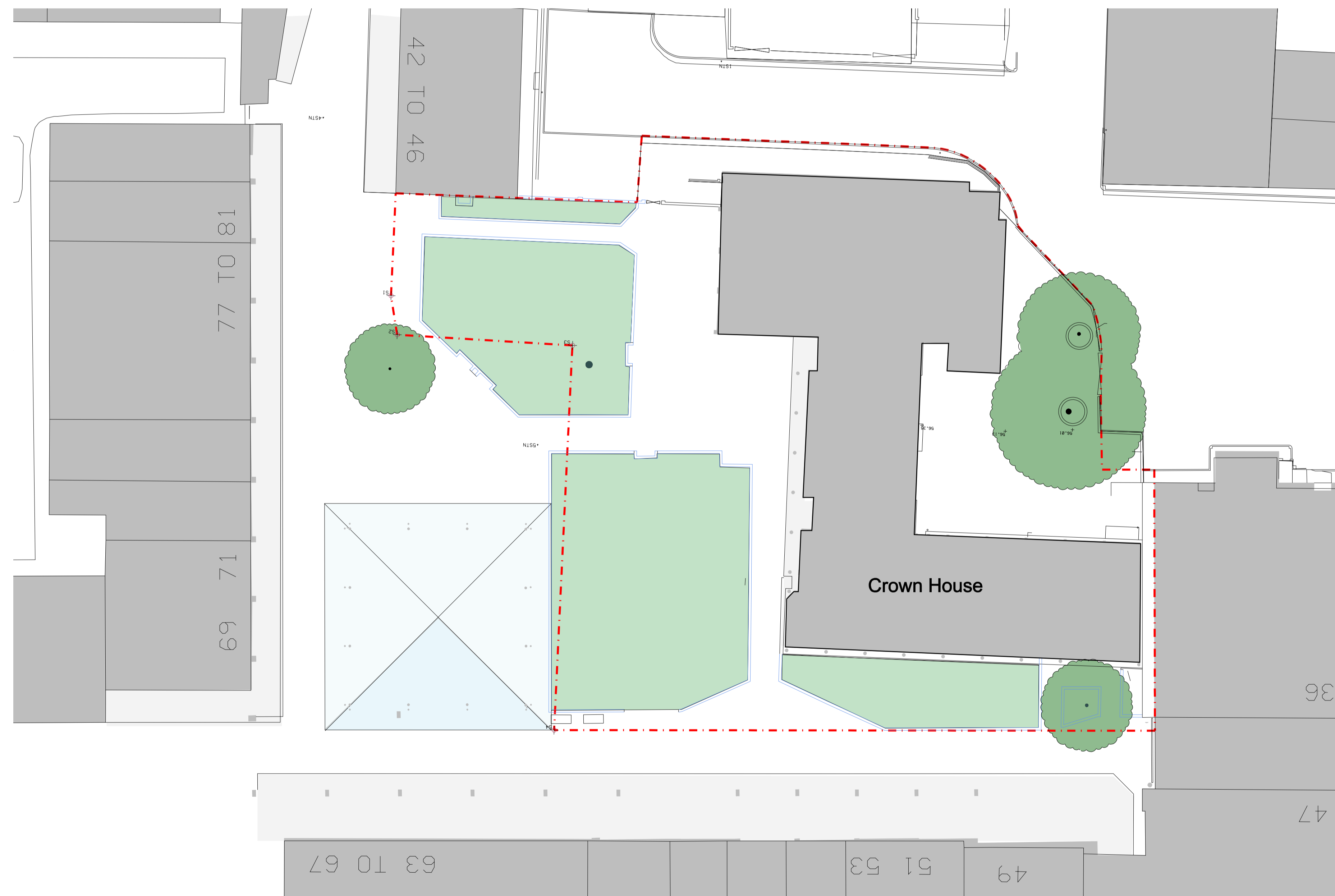
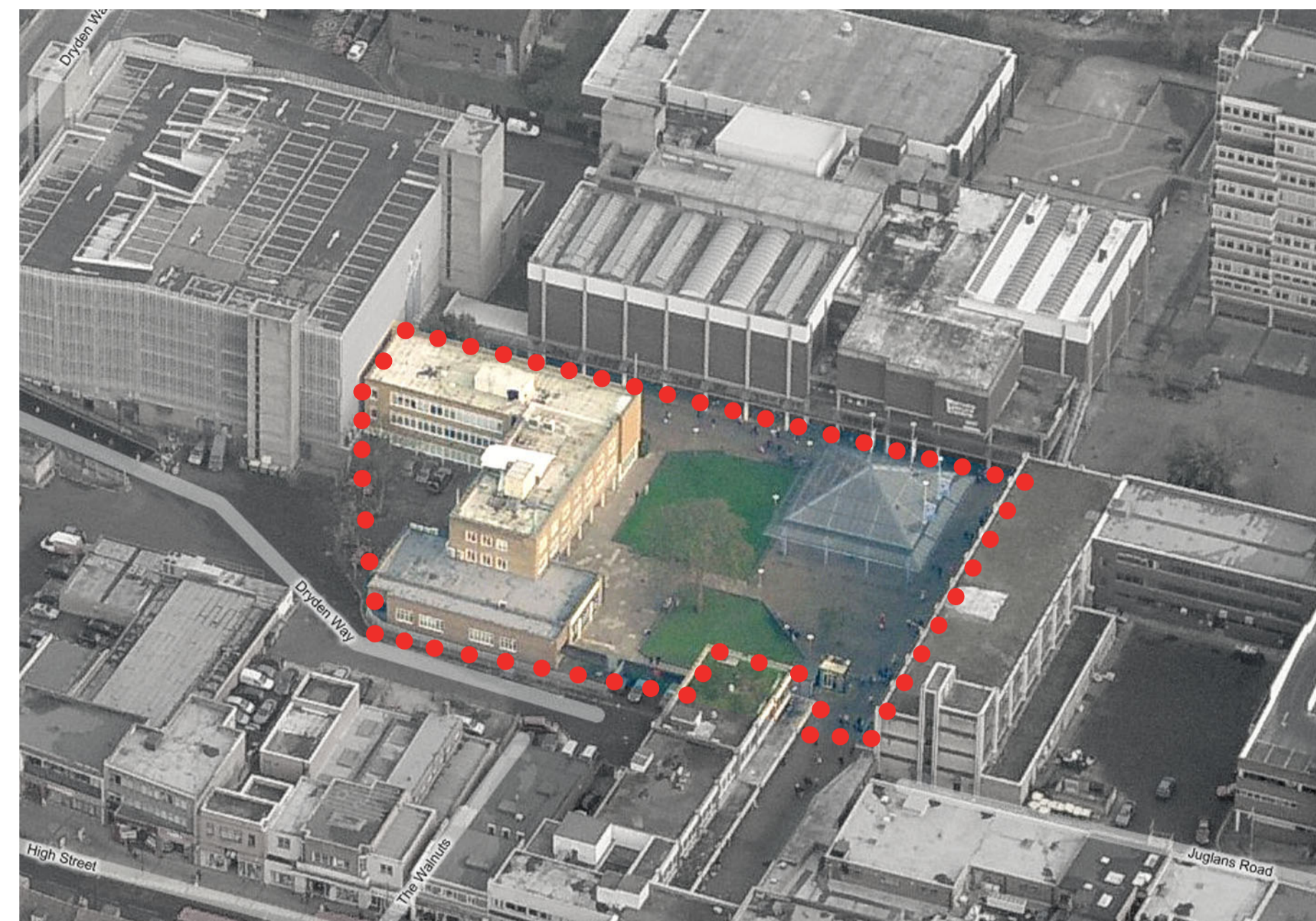

PROPOSAL

THE AIM IS TO DELIVER THE DEVELOPMENT OF A NEW HIGH QUALITY CINEMA, RETAIL AND RESTAURANT COMPLEX IN THE HEART OF ORPINGTON. THE REGENERATION WILL ALSO INVOLVE IMPROVING THE QUALITY OF THE PUBLIC REALM.

THE PROPOSAL HAS BEEN INSPIRED BY THE WALNUT-RELATED HISTORY OF THE SITE. IT IS PROPOSED THAT THE TREES PRESENTLY IN POOR CONDITION WILL BE REPLACED BY NEW WALNUT TREES IN THE SQUARE, WHILE ALTERNATING WALNUT COLOURED METAL PANELS WILL BE USED TO CLAD THE BUILDING.

PROJECT TIMESCALES 2013 - 2014

- > THE START OF CONSTRUCTION - EARLY 2013
- > RETAIL UNITS OPEN - WINTER 2013
- > CINEMA & RESTAURANTS OPEN - SPRING 2014

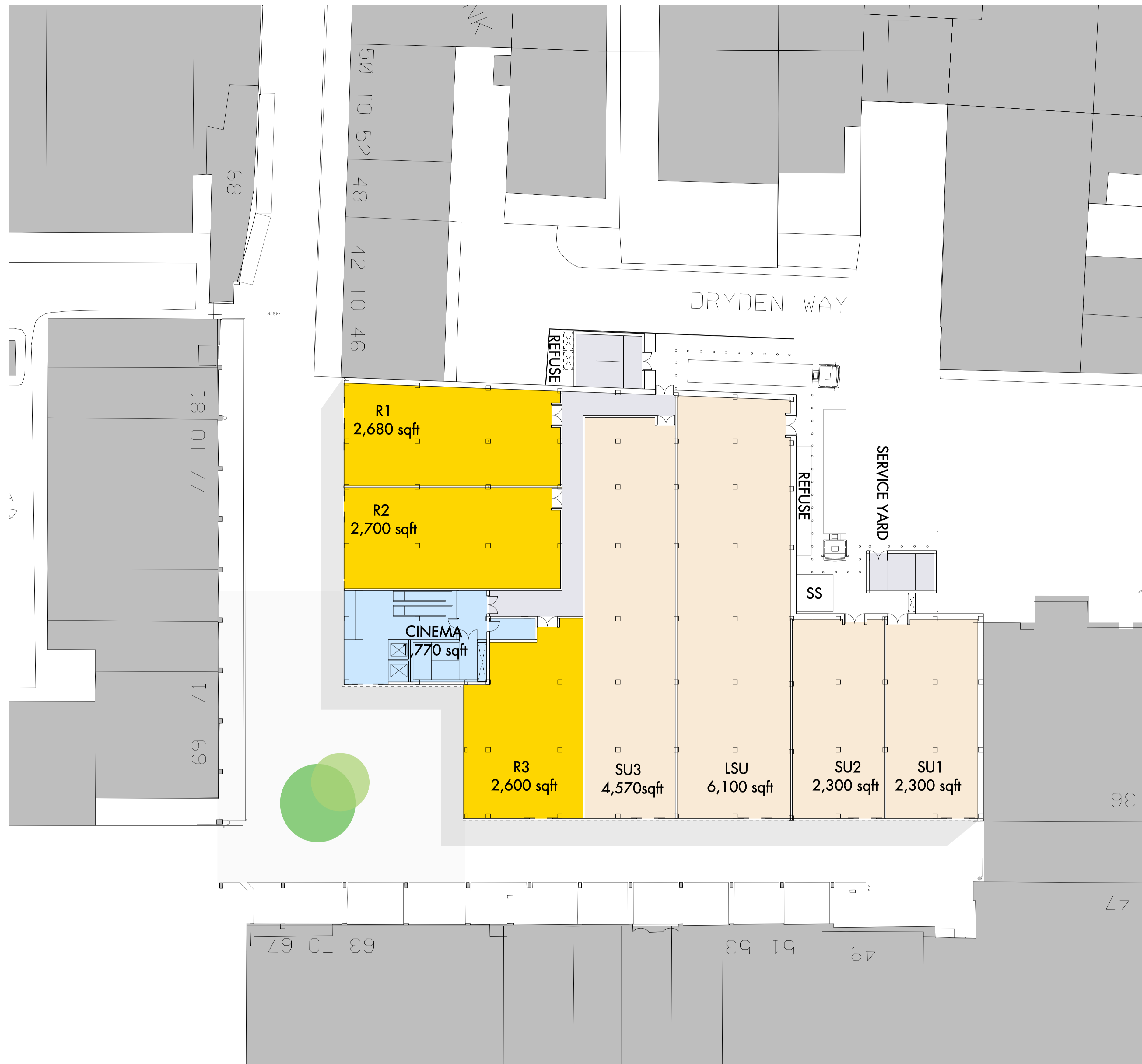

KEY OF USES



RESTAURANTS

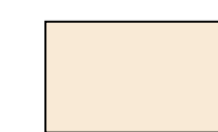

RETAIL SHOPS



CINEMA LOBBY

WALNUTS SQUARE / PROPOSED GROUND FLOOR PLAN

A NEW CINEMA

THE FIRST FLOOR OF THE BUILDING WILL BE OCCUPIED BY A SEVEN SCREEN ODEON CINEMA.

IT WILL FEATURE THE LATEST DIGITAL TECHNOLOGY, WITH LARGE COMFORTABLE SEATING AND AN ENTICING CONCESSIONS AREA.

THE CINEMA WILL BE OPEN SEVEN DAYS A WEEK, SHOWING THE LATEST FILMS.

THE CINEMA WOULD OPEN ITS DOORS IN JUST TWO YEARS TIME (IN THE SPRING OF 2014).

WE WELCOME YOUR COMMENTS & SUPPORT TO SEE THE TRANSFORMATION AND REGENERATION OF ORPINGTON TOWN CENTRE.



KEY OF USES



CINEMA SCREENS



WALNUTS SQUARE / VIEW FROM THE SHOPPING CENTRE ENTRANCE



WALNUTS SQUARE / VIEW INTO THE NEW WALNUTS PUBLIC SQUARE